

EXHIBITION & AWARD – EMERGENT: SEE

**Becroft Gallery
Lake House Arts Centre
37 Fred Thomas Drive
Takapuna**

Sunday 2019 03 10 (4pm Happening) – Saturday 2019 03 30 (3pm Awards Presentation)

EMERGENT: SEE is a Lake House Arts initiative to support an emerging artist every year. 2019 is the inaugural year and LHAC expect to see this initiative blossom in 2019 and flourish in the future.

Guest Curator Marion Breinhorst invites Tertiary Art Students and recent Graduates to participate in EMERGENT: SEE, the inaugural Lake House Arts Emerging Artist Awards and Exhibition open to all forms of art including (but not limited to)-

Painting, Print Media, Publication, Photography, Performance, Video, Virtual, Sculptural, Fashion, Drawing, Literature, Installation, Multi-media, Collaborative.

EMERGENT: SEE will provide one \$1000.00 award to the winning artist/s.

The judge for the award will be Lake House Arts Operations Manager Grae Burton in collaboration with a guest judge.

The Exhibition / Installation / Performance will begin on March 10. Delivery of entries, scheduling of performances and installations will be ongoing until March 24. Judging will conclude on March 28 with the Awards Event being held on Saturday March 30 at 3pm.

About Marion Breinhorst

Marion is a young artist currently studying at Elam School of Fine Arts whilst supporting a painting practice at home. Her practice explores various media to enrich the viewers perspective and is focused on familial bonds and social and personal values. The language of symbols and references to New Zealand Art History are recurring themes in her most recent works. Traditional practices such as icon painting are also explored in various pieces. Inspired by a multi-disciplinary art education, Marion has also previously crafted metal furniture and worked with publication media. As joint winner of The Perch Project 2016, a curatorial competition run by the Pah Homestead, Marion's curatorial experience has its roots within the local art scene.

Marion has worked in assistant curation and gallery assistance at Lake House Arts for the last 12 months. She is one of Lake House Arts top selling artists and her artwork will appear in Lake House Arts first exhibition for 2019 – Off The Wall.

Instagram: @st.jp2studio

About Grae Burton

Grae Burton is an experienced, award winning artist and creator of theatre and film. He is one of the most collected artists in the Wallace Arts Permanent Collection, with over 160 individual pieces and suites in the collection, including oil painting, digital photography, printed art, video art and virtual art. He is a former artist in residence at the Suter Theatre in Nelson where he performed a month-long mask installation art piece called transformative. He is a runner up in the Nelson Contemporary Art Awards (Rock of the Bay), winner of the Pain Awareness Art Award (Berlin Triptych), Nelson Environment Art Award (Era and the Kaitiaki) and has been a finalist in the Wallace Arts Awards numerous times. His short film Creep (2016) won multiple awards and commendations at international festivals. Previously he was Artistic Director of Nelson's Independent Theatre and Arts Centre (2006 – 2009), Core Company for The Ugly Shakespeare Company, Venue Manager and Special Projects Curator for the Wallace Arts Trust and Associate Producer for Wallace Productions Ltd (2011 - 2016), Associate Producer for Whoa! Productions (Custard's World) and took up the reigns at Lake House Arts Centre in June 2017 while continuing to produce art.

Eligibility

Tertiary art students studying in all art genres.

Recent Graduates (within 12 months of March 10, 2019) of Tertiary Art Programmes in all art genres.

Cost

Each individual artist is required to pay-

Size up to 1000mm x 1000mm - \$10 entry fee per artwork entry, up to three entries are allowed.

Size between 1000mm x 1000mm and 2000mm x 2000mm - \$20 entry fee, one entry per artist only.

Three artworks **total** per entering Artist/Artist Collective.

Multiple Element works will be charged as above per element. I.E. a triptych with elements under 1msq will be charged at \$10 per element = \$30.

The same charges apply to the surface area of the base of sculptural works.

Each Art Group/Collective, (two members or more), for Performance or Installation works required to pay \$20 per entry.

Payment must be made on delivery. Cash/Eftpos/Credit Card available.

Delivery of Artwork

To maximise exposure of artworks and artists we recommend delivery of artwork on-

- **March 9 between 10am and 2pm**
- **March 10 between 10:30am and 2pm**

Installation Art will happen within a schedule agreed prior between artist/s and Marion.

Artworks and entries will be accepted and installed **until Sunday 24th March.**

Guidelines for Entry/Participation

Performance works may be shown at the opening and can be scheduled for during the exhibition. Payment required when performance is scheduled. While each performance will be promoted performers take responsibility for promoting their own performance and working within the requirements and parameters of the building and grounds.

Artworks are encouraged to be for sale where appropriate.

Artists must consider Lake House Arts Centre is a Community and Family Facility. Young children and the elderly will make up a portion of the patrons during the event. Please discuss with Marion Breinhorst if you are unsure of artwork suitability, and timing of artwork install.

All artworks must be single edition.

Lake House Arts reserve the right to refuse entry of any artwork for EMERGENT: SEE

Lake House Arts reserve the right to amend guidelines and specifications for EMERGENT: SEE

For more info contact Guest Curator Marion on mbreinhorst@gmail.com

2D and Sculptural Art Specifications

Hanging works will be displayed on the wall when received. Artworks must have suitable D-rings for our hanging system. Hanging works have a maximum size limit of 2000mm x 2000mm.

Sculptural works may be indoor or outdoor works. Outdoor works are subject to the size limitations of indoor works and would remain outdoors overnight. Outdoor Artworks may only sit on the ground surface. The grounds may not be dug into or excavated. Lake House Arts does not take responsibility for damage or theft of outdoor works. Indoor maximum size limit; 1000mm square approx. base area X 2000mm tall.

Fashion pieces can display on coat-hangers attached to our wall hanging system, or, as indoor sculptural elements displayed on artist-provided mannequins.

Video and Audio artists may inquire about equipment hire or bring in personal equipment. Please discuss installation requirements of work with Lake House Arts before committing to entry. The Lake House Arts Digital Art and Virtual Art Studio is available for presentation.

Video Artworks may play on a playlist, depending of technical equipment availability.

To inquire about equipment, email manager@lakehousearts.org.nz

Installation / Performance Art Specification

Room in the gallery, (to be requested by artist(s). See the provided site map), available for rotation of small-scale installations within the parameters of the space. Each installation will have scheduled supervised install and deinstall hours during the exhibition season. **Please provide an installation proposal to accompany your application form- include a diagram of the proposed set up within the selected space, materials, and outline items which require wall hanging (include details of preferred hanging methods).** Email the proposal to Marion Breinhorst, mbreinhorst@gmail.com . Scheduling of install and deinstall times will be discussed.

Removal of any existing element on the walls or in the rooms or on the grounds of Lake House Arts is at the discretion of Lake house Arts and the expense of the artist/group/collective to re-position, repair and replace.

LAKE HOUSE ARTS EXHIBITION POLICY

EXHIBITION READY

Artworks must be submitted ready to exhibit. 2D artworks for wall hanging must have correctly installed D-Rings or metal loop screws with at least 5 millimeter diameter and be prestrung. Unframed works must enable the work to be hung with the Artitec Hook System used in the Gallery. Either by supplying plastic stick on hanging loops or by providing bulldog clips which will be attached to the artwork. Lake House Arts takes no responsibility for artworks which are not conventionally hung using gallery hanging systems. 3D works must be presentation ready. Lake House Arts has small plinths without covers. Any 3D works requiring special presentation platforms or plinths require the artist to supply the presentation system.

OVERSIZED AND NOT EXHIBITION READY WORKS

Oversized works and not exhibition ready works may not be presented in exhibition at the discretion of the management.

FINAL SIGN OFF

All Participants must sign the Submission Form and Agreement upon delivery of the artwork. By doing so All participants agree to all terms and conditions as presented in this Entry Form.

DESIGN:

Lake House Arts will plan the exhibition and installation with input and assistance from the artist or group at the sole discretion of the management and unless otherwise agreed in the terms of hire. Lake House Arts sets the standards for and design for any introductory signage, text panels, handouts or individual labels where applicable and in consultation the artist or group. Lake House Arts has final say on any matters discussed related to use of space and design for an exhibition.

STANDARD 2D & WALL HUNG INSTALLATION:

Lake House Arts use an ArtiTeq hanging system. See more here

(<https://www.artiteq.co.nz/shop/Picture+Hanging+Systems/Clickrail.html>)

All work needs to be framed, or have d-rings installed. Lake House Arts reserves the right to add d-rings to any artworks provided for exhibition that have not added them to the artwork. The supplier of the artwork will be charged \$5 for D-ring installation on their artwork.

Artiteq Picture Hanging Systems Click Rail

www.artiteq.co.nz

Hanging wall decorations in residential and commercial interiors, for pictures, posters and art works.

For work on paper we have 8 A3 Artiteq Poster display folders. <https://www.artiteq.co.nz/shop/Display-It.html>

Display-It with Artiteq

www.artiteq.co.nz

The span wire system Display-It is specially designed to make, and easily change, presentations on walls or freely in the room (for example in shop-windows).

Lake House Arts has a limited number of Display it Sets available. Artists may purchase additional 'Display-it' sets from Artiteq at their own cost. Additionally of paper and sketch works not framed artists can supply backing boards hung from our system on which paper work can be pinned.

NON-STANDARD 2D & WALL HUNG INSTALLATION:

All non-standard 2D and wall hung installation is at the sole discretion of Lake House Arts. Any damage to walls, floors or any other part of the exhibition space as a direct result of non-standard installation will be the responsibility of the artist or group to repair or replace. The artist or group shall also incur any additional costs for repair or replacement of damaged items or damage incurred to the exhibition space as a result of their exhibition.

FOR SCULPTURE AND 3D WORKS:

Lake House Arts has some stands and display tables for sculptural and 3D works which can be available to artists exhibiting. Museum Wax for securing works by Lake House Arts.

Lake House Arts does not provide glass or perspex/acrylic covers for display stands or tables. If the artist(s) wants their work covered they must provide at their own display equipment at their own expense and liability, and must seek permission from Lake House Arts for any use.

If the artist is not happy with the display equipment available from Lake House Arts they must provide at their own display equipment at their own expense and liability, and must seek permission from Lake House Arts for any use.

Works exhibited on the Gallery floor require permission from Lake House Arts and must be made safe and secure so as to not cause a hazard.

Any damage to walls, floors or any other part of the exhibition space as a direct result of installation will be the responsibility of the artist or group to repair or replace. The artist or group shall also incur any additional costs for repair or replacement of damaged items or damage incurred to the exhibition space as a result of their exhibition.

All display considerations are open for discussion between the artist and Lake House Arts.

SELECTION:

Lake House Arts has the final say on what works may or may not be included for display and the overall arrangement of art in the Gallery.

ADDITIONAL EVENTS:

Lake House Arts reserves the right to stage any private or public event or activity it sees fit in the Gallery Space at any time where it deems the event or activity will increase public access to the gallery.

Lake House Arts reserves the right to move or shift artworks in the gallery space as appropriate to stage events and activities. Shifted works will go back into exhibition positions for public viewing.

COPYRIGHT:

Copyright of images of the artist's work, exhibition and publication text, remain the property of the exhibiting artist.

Except for the purpose of publicity, reporting, critical review and installation record the gallery will not copy, photograph, or otherwise reproduce or transmit any part of the exhibition or artists work without prior permission from the artist.

CHAIN OF TITLE AND IMAGE USE PERMISSION:

The artist/group warrants that they solely own or represent all intellectual property and copyright in the artworks presented for the exhibition under their name or organisation/group.

The artists gives permission to Lake House Arts and it's representatives to use imagery of artworks used in the exhibition, images of the artists and creators involved and any additional logos, branding or otherwise associated with the exhibition to promote the exhibition on any and all media platforms.

INSURANCE AND DAMAGE TO ARTWORKS:

Insurance of the artworks while on display at Lake House, in transit to and from Lake House, is the responsibility of the artist.

Lake House will take all care but no responsibility for artworks that are unstable or poorly exhibited which may result in damage. Lake House has no storage facility for artwork after the exhibition take down.

Lake House Arts Centre and/or The Lake House Trust will not be liable in any way for damage or theft of artworks onsite and/or on exhibition at Lake House Art Centre.

ABANDONED WORK:

Work left for longer than three months will be sold to defray expenses. Price of Sale will be at the Sole discretion of Lake House Arts.

SECURITY, EVACULATION AND SAFETY POLICY:

Lake House Arts Centre has a standard security monitoring service which includes: Centre staff, an after hours alarm system, camera's and security monitoring service. Lake House has a health and Safety Policy as well as an evacuation plan.

Creation of work – including materials and framing, professional packing and delivery on time.

Supply of biographical notes and images for publicity and exhibition label information on the dates discussed with the Lake House.

Liaison with staff on display concepts.

Exhibition extension activities - floor talk (if applicable) and attendance at exhibition opening.

Collection of work by collection date. Any artwork that is not collected by the date specified without alternative arrangements will become the property of the Lake House Art Centre.

DELIVERY:

Consignment of Objects to Lake House Arts Centre, Attention: Grae Burton.

37 Fred Thomas Dr, Takapuna, Auckland 0740.

Ph: 486 4877

Email: manager@lakehousearts.org.nz

ARTWORK INFORMATION

The Artist must supply all specific information as requested by Lake House Arts in the form and layout requested by Lake House Arts. This may be an online or physical form for the Artist to fill out.

SALE OF ARTWORK AGREEMENT

The ARTIST agrees the LAKE HOUSE ARTS CENTRE has the right to sell the listed and received artwork for the duration of the exhibition as stated in this agreement. THE ARTIST agrees to the following-

SALE OF WORK, TAX OBLIGATIONS, HIRES and FEES:

All work will be for sale. The ARTIST nominates the sale price. Sale price must include LAKE HOUSE commission - 35% + GST. Lake House Arts takes a 35% commission on sales and an additional 15% GST on top of the 35% commission, this means if you retail a piece at \$100, Lake House will take \$35 commission plus \$5.25 GST making your income \$59.75. Price your work with this in mind. Please let us know if you need an additional sections or to include additional information.

Any tax obligations incurred such as Income or Provisional Tax and GST (where applicable), is the responsibility of the artist.

The ARTIST will supply all relevant bank account details for ease of payment when works are sold. Artists will receive payment for their artworks after the exhibition has closed and Lake House has received the payment in full from the purchaser.

Payment will be made no later than the 20th of the following month after the closing date for the exhibition - i.e: If your exhibition closes on April 1st, you can expect to receive payment by May 20th.

BY SIGNING THE ARTIST(S) AGREES TO ALL TERMS AND CONDITIONS

ARTIST(S) TO SIGN HERE (ON DELIVERY)

DATE

SIGNED ON BEHALF OF LAKE HOUSE ARTS

EMERGENT: SEE ALL GUIDELINES AND POLICIES FOR SIGN OFF BY PARTICIPANTS

DATE

FLOOR PLAN FOR PUBLIC AREAS AT LAKE HOUSE ARTS.

WALL SPACE AND FLOOR SPACE IN AND AROUND THE MAIN BUILDING MAY BE USED FOR 2D AND 3D ARTWORKS. THERE ARE ALSO EXTENSIVE GROUNDS AVAILABLE FOR USE BY THE ARTIST/S FOR INSTALLATION / PERFORMANCE / PRESENTATION.

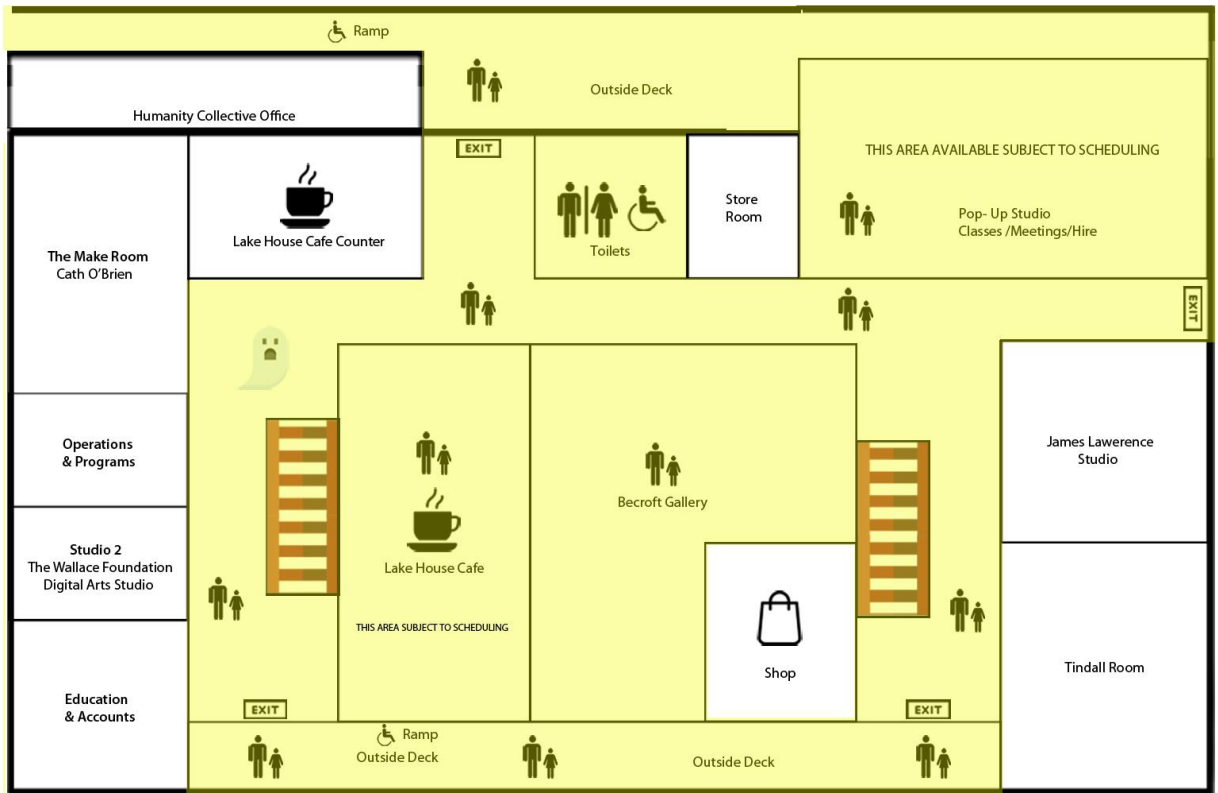

Public Areas marked in YELLOW



Large Courtyard

Lake House Arts Center
Level One Ground Floor Map

EMERENT: SEE ALL GUIDELINES AND POLICIES FOR SIGN OFF BY PARTICIPANTS

 Public Areas Marked in YELLOW

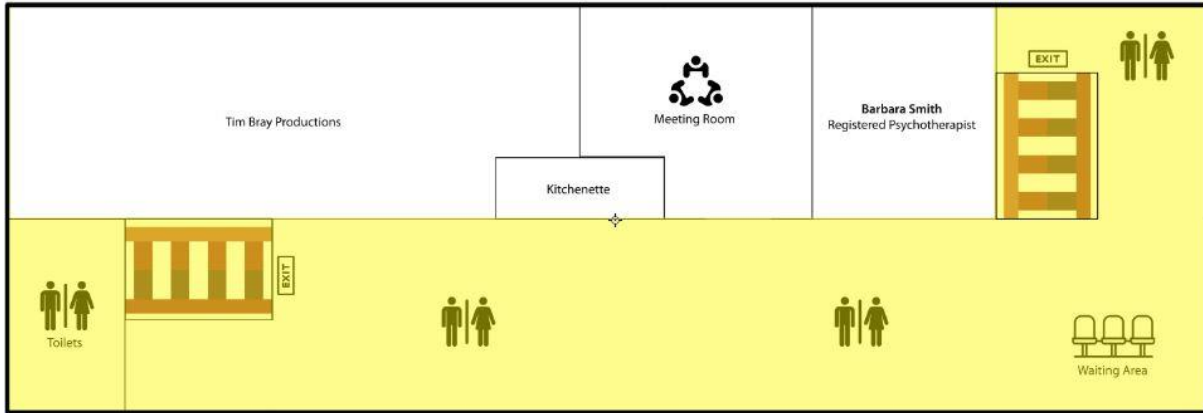

Lake House Arts Center
Second Floor Map

FEEL FREE TO ENQUIRE ABOUT SPECIFIC USE OF SPACE. VIDEO CAN BE PROVIDED.